

IMPORTANT NOTICE

TO: All Homeowners and residents

AFFECTED STREETS: Paddington Station and Waterloo Station

NOTICE DATE: October 16, 2020

Mullen's Markings is scheduled to paint parking space numbers on to the curbs on Paddington Station and Waterloo Station. The current schedule at this time, subject to weather and/or production conditions, is as follows:

- October 22nd , work begins at approximately 8:00 AM

The parking spaces depicted in the attached aerial photos and circled in **RED** must be vacant by 7 AM on October 22nd. Any vehicle found parked within any of these spaces will be towed at the owner's risk and expense. It is anticipated that this project will take one day.

The numbering sequence depicted on the maps has been established and is not subject to change.

If you have any questions or have special circumstances that would warrant further assistance, please contact Larry Gilbert at SFMC at lgilbert@sfmtcinc.com.

YOUR PATIENCE AND COOPERATION WILL BE VERY MUCH APPRECIATED!

A

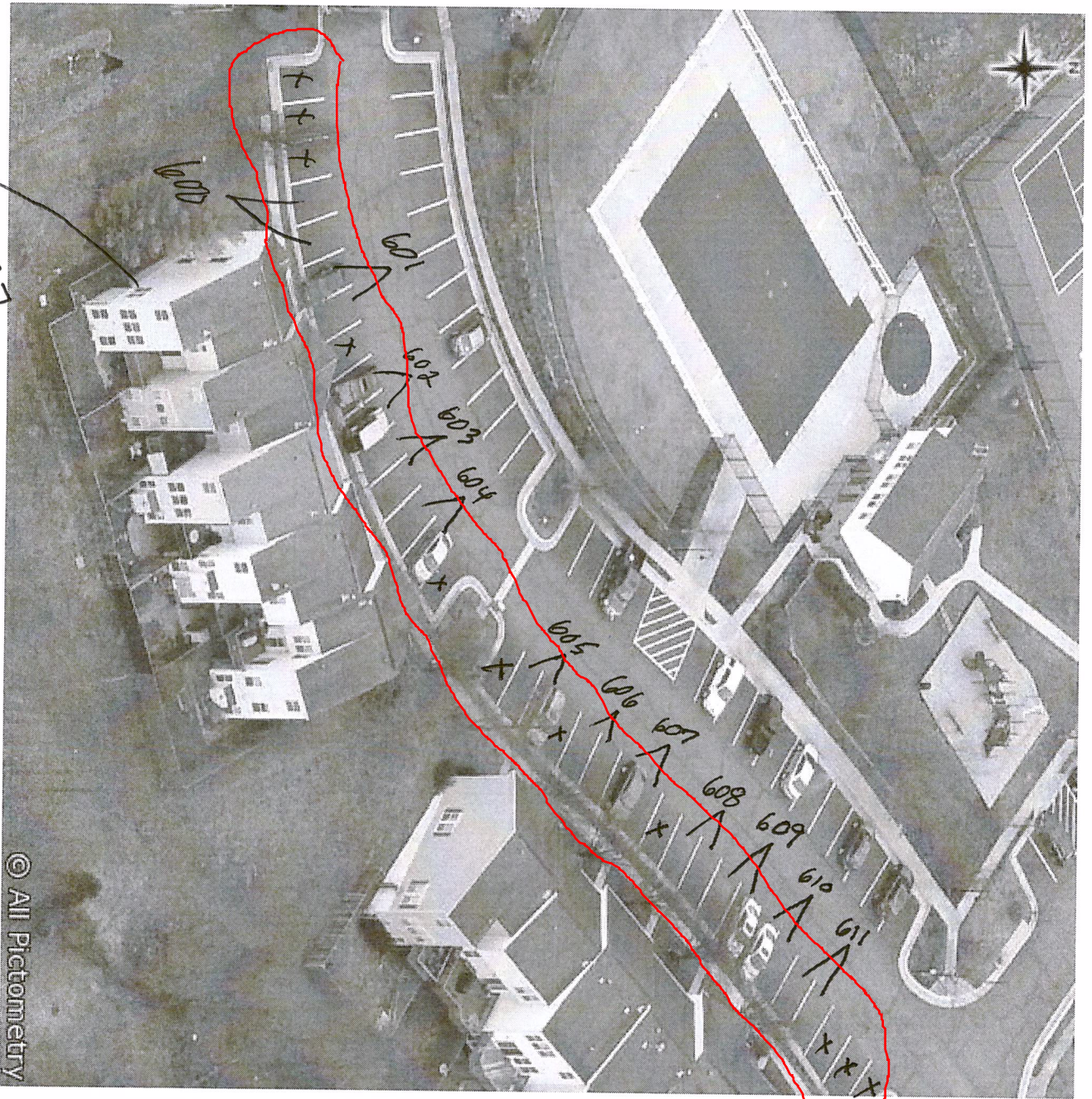

45637
PADDINGTON

A



B

PADDINGTON

B



PADDINGTON

45691

C

A



B

WATERLOO

03/25/2019

B



C

WATERL00



C

WATERLOO

© All Pictometry